

SAMMYS®

Anchors for Wood

Installs into Wood
Structures Easily
and Quickly!

Available
in Vertical
and Horizontal

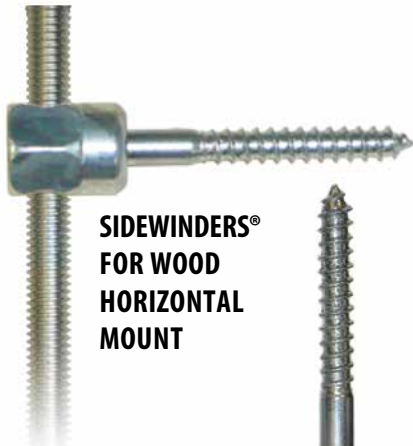

**SIDEWINDERS®
FOR WOOD
HORIZONTAL
MOUNT**

VERTICAL MOUNT

DESCRIPTION/SUGGESTED SPECIFICATIONS

Self drilling & self-tapping into wood—

The Wood Sammy is perfect for Hanging Sprinklers, Pipes, Electrical Fixture or HVAC Equipment to wood joist, 2x4, OSB, plywood and wood beams. It is available in 1/4", 3/8" and 1/2" threaded coupling. The Wood Sammy is available in vertical mount, horizontal mount, and Swivel mount to accommodate all fastening situations.

ADVANTAGES

- No pre-drilling required.
- Quick to install using the Sammy Nut Driver with no load speed 2000-2500 rpm, minimum 6 amps drill/driver.
- Saves time from traditional methods.
- Reduces installation cost.
- Made in the U.S.A.

Sammy's Vertical Mount Product Features

Not less than
2" nominal width (1-1/2")

Not less than
3" nominal
thickness (2-1/2")
(depth or side
of vertical member)

For vertical use -
install in center of lower face.
Minimum 2" embedment into base
material for NFPA 13 compliance.

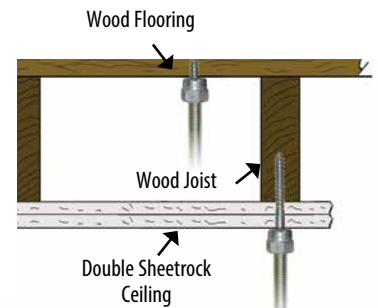

Composite / Truss

Consult truss manufacturer
for recommended
installation point.

*Pre-drilling may be required
for GST 25-380. Tool
available on page S 17.

Sammy's Sidewinder® Product Features

Not less than 2" nominal width (1-1/2")
up to 3-1/2" pipe; not less than 3" (2-1/2")
nominal width 4" & 5" pipe

Minimum 2-1/2" from bottom
for branch lines. Minimum 3"
from bottom for main lines.
Exception: This requirement
shall not apply to 2" or thicker
nailing strips resting on top of
steel beams.

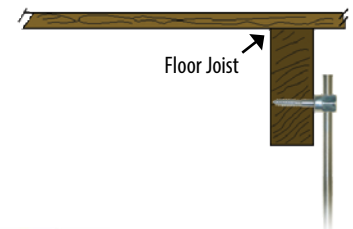

Composite/Truss

Consult truss manufacturer
for recommended
installation point.

*Pre-drilling may be required
for Model SWG 25-380 (tools
available on page S 17)

SAMMYS®

ITW Construction Products

Call our toll free number 800-387-9692 or visit www.itwconstruction.ca for general information.

APPLICATIONS



- Sprinkler Systems
- Pipes/Plumbing
- Electrical Lighting and Fixtures
- HVAC Equipment and Fixtures

APPROVALS

See Selection Chart for items with approvals.

INSTALLATION INSTRUCTIONS VERTICAL MOUNT

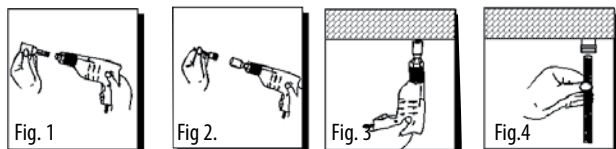

1. Insert the appropriate nut driver into a 3/8" or 1/2" portable drill.
2. Insert the SAMMYS into the #14 (black) nut driver (p/n 8113910). Drill should be in a vertical position.
3. Push the face of the nut driver tight to the member. When the nut driver spins freely on the SAMMYS, stop drill and remove.
4. The SAMMYS is now ready to receive 1/4", 3/8", 1/2" or metric all thread rod, bolt stock. (The 1/2" requires the #14SW red nut driver)

Important Vertical Installation Notes

Warranty requires the use of appropriate nut drivers for installation.
Model #14 Nut Driver Item No: 100 Color: Black Use With Sammys for 1/4" and 3/8" Rod PN 8113910
 Eye protection should be worn at all times when installing this product.

INSTALLATION INSTRUCTIONS HORIZONTAL MOUNT

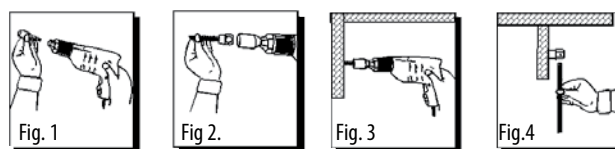

1. Insert the appropriate nut driver into a 3/8" or 1/2" portable drill.
2. Insert the SAMMYS into the #14W (red) nut driver (p/n 8114910). With drill unit in a horizontal position and at a right angle to the structural member, begin installation.
3. When the nut driver spins free on the SAMMYS, stop drill and remove.
4. The unit is now ready to receive 1/4", 3/8", or metric all thread rod, bolt stock.

Important Horizontal Installation Notes

Warranty requires the use of appropriate nut drivers for installation. Sidewinders must be installed using **Model #14SW (Red) nut driver only. Item No: 101 PN: 8114910**
 Eye protection should be worn at all times when installing this product.

SELECTION CHART

SAMMYS Vertical Mount

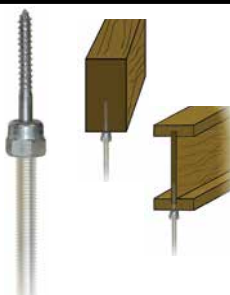

ROD SIZE	PART NUMBER	MODEL	DESCRIPTION	ULTIMATE PULLOUT (LBS)	UL LISTED	TEST LOAD (LBS)	FM APPROVED	TEST LOAD (LBS)	BOX QTY	CASE QTY	NUT DRIVER
3/8"	8008957	GST 20	1/4 x 2"	1760 (Fir)	850	1475	25	125	Part # 8113910		
3/8"	8010957	GST 30	1/4 x 3"	2060 (Fir)	1500	1475	25	125			

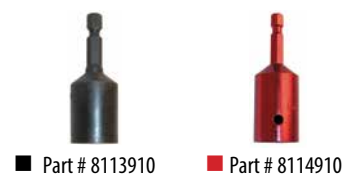

SAMMYS Horizontal Mount

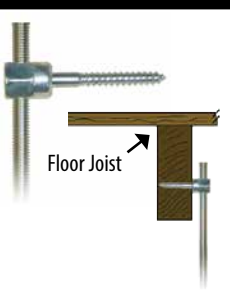

ROD SIZE	PART NUMBER	MODEL	DESCRIPTION	ULTIMATE PULLOUT (LBS)	UL LISTED	TEST LOAD (LBS)	BOX QTY	CASE QTY	NUT DRIVER
3/8"	8021957	SWG 20	1/4 x 2"	1725 (Fir)	1050	25	125	Part # 8114910	

SPECIAL NUT DRIVER SYSTEM: The nut drivers were designed with a unique spin-off feature which provides a fast and safe installation each time. When the face of the driver comes into contact with the material you are installing into, continue drilling until nut driver spins free. Installation is then complete. Warranty requires the use of the appropriate nut driver for installations.

SAMMYS for Wood – Seismic Restraint



SIDEWINDER FOR 3/8" RODS

SWG 20 FOR 3/8" ROD



Structural attachment fitting for installation of branch/end of line restraint using 3/8" threaded rod. Designed for use in wood structural member with a minimum thickness of 2" (nominal 1-1/2"). Can be used in composite wood joists; consult manufacturer for recommended installation point. These fastening systems provide a secure and economical attachment to the structure.

The SWG 20 model provide a one-piece upper structural attachment in a wide range of wood thicknesses.

SPECIFICATIONS

- Restrained Pipe Size:** Up to Schedule 40 pipe 2" or less
- Max Length of Restraint Material:** See Maximum Horizontal Load Tables below.
- Maximum Angle:** 45° from horizontal
- Material:** Carbon Steel
- Screw Description:** (SWG 20): 1/4"-10 x 2" wood screw
- Finish (both):** Electro-zinc (cap & fastener)
- Testing:** BX Report # R-1362
- Listing:** UL 203 as a pipe hanger
UL 203A pending 
- Installation:** Must be installed with #14 SW Red Nut Driver (Part No. 8114910)

SELECTION CHART

SAMMYS for Wood – Seismic Restraint

ROD SIZE	PART NUMBER	MODEL	MIN THICKNESS	APPLICATION	BOX QTY	CASE QTY
3/8"	8021957	SWG 20	1-1/2"	Wood, Dim. Lumber, TGI/TJI Joist	25	125

PERFORMANCE TABLES

Maximum Rod Length for I/r=100, 200, 300, and 400

RESTRAINT SHAPE AND SIZE	NOMINAL DIAMETER	AREA (in. ²)	LEAST RADIUS OF GYRATION, r (in.)	MAXIMUM ROD LENGTH FOR I/r (ft)			
				I/r = 100	I/r = 200	I/r = 300	I/r = 400*
Rods (all thread)	3/8 in.	0.07	0.075	0.6	1.3	1.9	2.5
	1/2 in.	0.129	0.101	0.8	1.7	2.5	3.4
Rods (threaded at ends only)	3/8 in.	0.11	0.094	0.8	1.6	2.4	3.1
	1/2 in.	0.196	0.125	1.0	2.1	3.1	4.2

Reference: NFPA 13, (2007)

* Reference: NFPA 13, (2010)